

Type **TVR60**

Check valve

of steel



General

DESCRIPTION



Features

- Galvanised steel
- Prevent fluid return in the circuit
- Metal-to-metal sealing system, without o-ring
- Highly resistant to stress during pressure peaks

The new series of steel check valves were developed specially for oil and hydraulic applications in industry and agriculture.

TVR60 check valves are equipped with a metal seal as standard. Elastomeric sealing materials on request. It is the customer's responsibility to clarify the media compatibility.

Application

Hydraulic (oils of fluid group 2 within the meaning of the Pressure Equipment Directive 2014/68/EU) and pneumatic applications in industry, agriculture and construction machinery.

TECHNICAL DATA

Characteristics	Basic version	Options
Media inlet B1 / media outlet B2	Internal thread: G1/8" - G1 1/4"	NPT thread on request
Nominal bore DN	4 up to 32 mm, acc. to design	
Max. allowable operating pressure PS	300 bar, acc. to design	
Cracking pressure PC	Approx. 0.35 bar	On request
Temperature range	-20 °C up to max. +300 °C	On request
Material	Housing in galvanised steel	On request
Sealing material	Metallic	On request
Sealing concept	Metallic sealing, without o-ring	On request

Ordering

ORDERING | TVR60 Check valve with internal thread on both sides (DIN EN ISO 228-1)

approx. dimensions (mm)

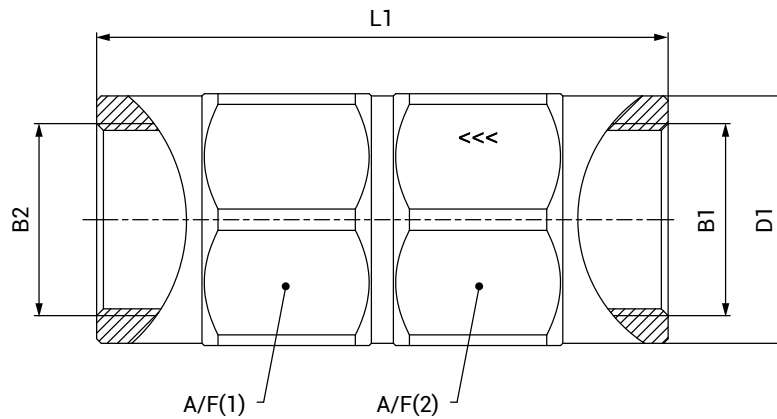

Part No.	DN	B1 (internal thread)	B2 (internal thread)	PS (bar)	PC (bar)	L1	D1	A/F(1) / A/F(2)
C1-90389	4	G1/8"	G1/8"	300	0.35	44.0	15.0	14
C1-90390	6	G1/4"	G1/4"	300	0.35	56.0	18.5	19
C1-90391	10	G3/8"	G3/8"	300	0.35	70.0	21.6	22
C1-90392	13	G1/2"	G1/2"	300	0.35	77.0	29.5	30
C1-90393	20	G3/4"	G3/4"	300	0.35	90.0	35.0	36
C1-90394	25	G1"	G1"	300	0.35	106.3	44.5	46
C1-90395	32	G1 1/4"	G1 1/4"	300	0.35	125.0	54.0	55

Other connection sizes and versions on request.

Required information for request / ordering see page 5, catalogue no. 45.

Other products

OTHER PRODUCTS

You will find more products in our current catalogue no. 45



Further information on our homepage
www.weh.com

Illustrations

The illustrations and/or images used in this data sheet are particularly provided for illustrative purposes only and may differ in some details from the actual product. For binding information, please refer to your individual orders.

Abbreviations/Definition

Explanation of abbreviations see technical appendix in the catalogue or www.weh.com

Safe product selection

Our WEH® Products are designed to be operated by qualified professional users (insofar as WEH® Products are also designed to be operated by other users in individual cases, this is explicitly stated in the corresponding operating instructions). You alone are responsible for the selection of WEH® Products and their configuration according to the requirements of your system. In doing so, please particularly consider your intended use, your performance data, your material compatibility, your system concept and your system limits as well as your technical and legal requirements for operation, handling and maintenance. The quality and safety of WEH® Products is our highest priority. For this reason, WEH® Products may not be used outside the specifications in the relevant data sheets and product descriptions. We also strongly recommend that you refrain from using third-party spare parts or a combination of WEH® Products with unsuitable third-party products. You alone are responsible for reviewing the suitability of third-party products. WEH® Products and WEH® Spare parts comply with our quality and safety standards.

Explanation on the Pressure Equipment Directive

These WEH® Products are generally and exclusively classified as pressure accessories for piping in accordance with Article 2 (5) of the Pressure Equipment Directive 2014/68/EU. These WEH® Products may not be used (i) as safety accessories or (ii) for vessels as defined by the Pressure Equipment Directive 2014/68/EU. Therefore, the application of these WEH® Products must comply with their classification as pressure accessories for piping. The assessment with regard to a different classification can, however, be made on request.

External change management

WEH reserves the right to update, optimise and adjust its products continuously. This may result in corresponding changes of the product. Customers will be informed proactively or unsolicited by WEH only in individual cases about product updates, product optimisations and/or product adaptations that have been carried out. You are free to contact WEH at any time to request information about any product updates, product optimisations and/or product adjustments.

© All rights reserved, WEH GmbH. Any unauthorized use is strictly forbidden. Subject to alteration.
No liability will be assumed for any content. Herewith previous versions are no longer valid.

» Contact

For queries and further information, please do not hesitate to contact us.

Manufacturer:

WEH GmbH Precision Connectors

Josef-Henle-Str. 1
89257 Illertissen / Germany

Phone: +49 7303 9609-0

Email: sales@weh.com

www.weh.com