

# Type **TVR60**

Steel Check Valve



**General**

**DESCRIPTION**



**Features**

- Galvanised steel
- Prevent fluid return in the circuit
- Metal-to-metal sealing system, without o-ring
- For applications with reduced demands concerning leak tightness in the valve seat
- Highly resistant to stress during pressure peaks

The new series of steel check valves were developed specially for oil and hydraulic applications in industry and agriculture.

**Application**

Oil and hydraulic applications in industry, agriculture and construction machinery.

**TECHNICAL DATA**

Characteristic	Basic version	Options
Port A / B	Internal thread: G1/8" - G2"	Inlet: external thread on request
Nominal bore DN	4 up to 50 mm	On request
Operating pressure PS	Max. 300 bar, acc. to body size	On request
Cracking pressure PC	Approx. 0.35 bar	Approx. 1 bar / 2.5 bar / 4.5 bar / 6 bar / 8 bar Other cracking pressures on request
Temperature range	-20 °C up to max. +300 °C	On request
Medium	On request	On request
Material	Housing in galvanised steel	On request
Valve seat	Metallic sealing cone seat, without o-ring	On request
Approval	PED97/23/EC	

**Ordering**

**ORDERING** | TVR60 with internal thread on both sides (DIN ISO 228-1)

approx. dimensions (mm)

Design 2

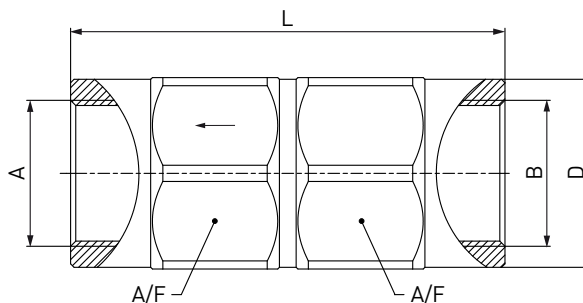

Design 3

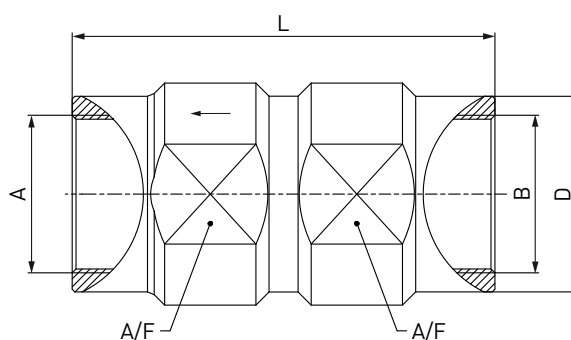

Part No.	Design	DN	A / B	PS (bar)	PC (bar)	L	D	A/F
<b>C1-90389</b>	2	4	G1/8" internal thread	300	0.35	44	15	14
<b>C1-90390</b>	2	6	G1/4" internal thread	300	0.35	56	18.5	19
<b>C1-90391</b>	2	10	G3/8" internal thread	300	0.35	70	21.6	22
<b>C1-90392</b>	2	12	G1/2" internal thread	300	0.35	77	29.5	30
<b>C1-90393</b>	2	20	G3/4" internal thread	300	0.35	90	35	36
<b>C1-90394</b>	2	25	G1" internal thread	300	0.35	106.3	44.5	46
<b>C1-90395</b>	2	31	G1 1/4" internal thread	300	0.35	125	54	55
<b>C1-90396</b>	2	40	G1 1/2" internal thread	300	0.35	140	59	60
<b>C1-90397</b>	3	50	G2" internal thread	200	0.35	160	74	75

Other connector sizes and versions are available on request.

## Other products

### OTHER PRODUCTS

Our check valve catalogue contains further steel or stainless steel check valves.



Further information on our homepage  
[www.weh.com](http://www.weh.com)

#### » Contacting

For queries and further information, please do not hesitate to contact us.

*Manufacturer:*

**WEH GmbH Precision Connectors**

Josef-Henle-Str. 1  
89257 Illertissen / Germany

Phone: +49 7303 9609-0

Fax: +49 7303 9609-9999

eMail: [sales@weh.com](mailto:sales@weh.com)

[www.weh.com](http://www.weh.com)